



# ARMOUR RODS

ALDA

## ARMOUR RODS

For aluminum conductors

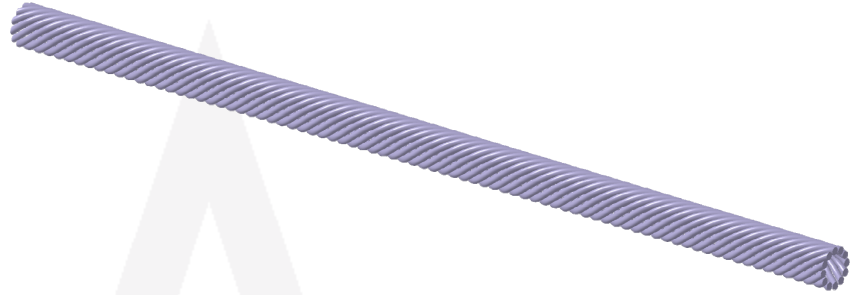
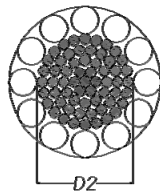
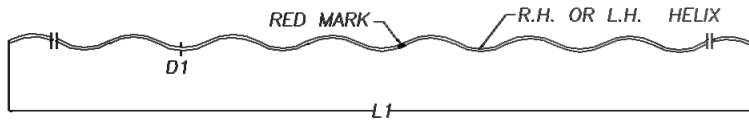

No.	Part No.	Dimensions (mm)			No. Of Rods Per Set	Lay Direction	Conductor	Weight Per set (Kg)
		L1	D1	D2				
1	AR.08.37	1194	3.7	8.37	8	R.H.	ACSR FOX (Ø8.37mm)	0.30
2	AR.10.05.2	1350	4.2	10.05	9	L.H.	ACSR RABBIT (Ø10.05mm)	0.51
3	AR.13.95	1520	5.2	13.95	10	R.H.	ACSR HORSE	0.96
4	AR.15.01	1520	5.2	14.57	10	R.H.	ACSR HYENA	1
5	AR.16.03	1620	5.2	16	11	R.H.	ACSR DORKING	1.03
6	AR.16.28	1620	5.2	16.28	11	R.H.	ACSR PARTRIDGE	1.03
7	AR.17.45	1730	5.2	17.45	12	R.H.	ACSR 105/75 mm <sup>2</sup>	1.2
8	AR.18.01	1830	5.2	18.13	12	R.H.	ACSR WOLF	1.3
9	AR.19.57	1830	5.2	19.53	13	R.H.	ACSR LYNX	1.4
10	AR.19.60	1930	6.4	19.6	11	R.H.	ASTER 228mm <sup>2</sup> (Ø19.6mm)	2
11	AR.21.50	1980	6.4	21.8	12	R.H.	ACSR HAWK	2.1
12	AR.24.00	2130	6.4	24	13	R.H.	ACSR 300/39mm <sup>2</sup> (Ø24mm)	2.5
13	AR.24.20	2130	6.4	24.19	13	R.H.	ACSR PEACOCK (Ø24.2mm)	2.5
14	AR.24.20-2	2130	6.4	24.5	13	R.H.	ACSR 300/50mm <sup>2</sup>	2.5
15	AR.23.60	2130	6.4	24.51	13	R.H.	ACSR SQUAB	2.5
16	AR.24.85	2130	6.4	24.85	13	R.H.	AAAC 366mm <sup>2</sup> (Ø24.85mm)	2.5
17	AR.25.24	2340	7.9	25.24	11	R.H.	ACSR TEAL	3.75
18	AR.27.50	2440	7.9	27.45	12	R.H.	ACSR 400/51 mm <sup>2</sup> (Ø27.5mm)	4
19	AR.27.63	2440	7.9	27.63	12	R.H.	LGJ 400/50 mm <sup>2</sup> (Ø27.63mm)	4
20	AR.27.50.2	2440	7.9	27.68	12	R.H.	ACK 400/51 mm <sup>2</sup> (Ø27.68mm)	4
21	AR.27.72	2540	7.9	27.72	12	R.H.	ACSR CONDOR (Ø27.72mm)	4.3
22	AR.28.11	2540	7.9	28.11	12	R.H.	ACSR DRAKE (Ø28.11mm)	4.3
23	AR.28.97	2540	7.9	29.52	13	R.H.	ACSR CANARY	4.7

See the next page

**ALDA MANUFACTURING CO.**

No. 7, Maryam Alley, Hakim Highway, Tehran-Iran ■ Postal Code: 1473666751

Tel: (+9821) 44003214-6 ■ Fax: (+9821) 44003217

Email: [Info@AldaCompany.com](mailto:Info@AldaCompany.com)



## ARMOUR RODS

For aluminum conductors

No.	Part No.	Dimensions (mm)			No. Of Rods Per Set	Lay Direction	Conductor	Weight Per set (Kg)
		L1	D1	D2				
24	AR.29.61	2540	7.9	29.61	13	R.H.	ACSR RAIL	4.7
25	AR.30.38.2	2540	7.9	30.38	13	R.H.	ACSR 547.8mm <sup>2</sup>	4.7
26	AR.30.42	2540	7.9	30.42	13	R.H.	ACSR CARDINAL (Ø30.42mm)	4.7
27	AR.30.51	2540	9.3	30.51	12	R.H.	AAAC 551mm <sup>2</sup> (Ø30.51mm)	6
28	AR.30.60	2540	9.3	30.6	12	R.H.	ACSR 500/64mm <sup>2</sup> (Ø30.60mm)	6
29	AR.30.60.2	2540	9.3	30.6	12	R.H.	ACSR 490/65mm <sup>2</sup> (Ø30.60mm)	6
30	AR.31.05	2540	9.3	31.05	12	R.H.	AAAC ASTER 570mm <sup>2</sup> (Ø31.05mm)	6
31	AR.30.45	2540	9.3	31.68	12	R.H.	ACSR CURLEW (Ø31.68mm)	6
32	AR.32.40	2540	9.3	32.4	12	R.H.	ACSR 550/70mm <sup>2</sup>	6
33	AR.34.17	2540	9.3	34.17	13	R.H.	ACSR BITTERN (Ø34.17mm)	6.5
34	AR.32.54	2540	9.3	36.17	14	R.H.	ACSR MARTIN (Ø36.17mm)	7.5
35	AR.40.70	2540	11	40.7	13	R.H.	ACSR CHUKAR (Ø40.70mm)	9.1



**ALDA MANUFACTURING CO.**

No. 7, Maryam Alley, Hakim Highway, Tehran-Iran ■ Postal Code: 1473666751

Tel: (+9821) 44003214-6 ■ Fax: (+9821) 44003217

Email: [Info@AldaCompany.com](mailto:Info@AldaCompany.com)

## ARMOUR RODS

For alumoweld earth wires

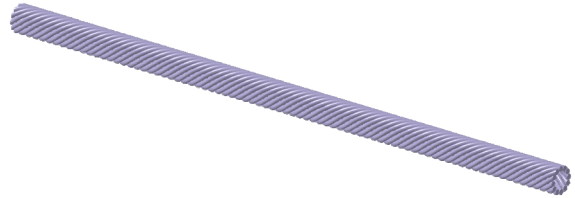
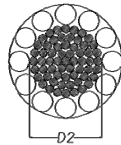
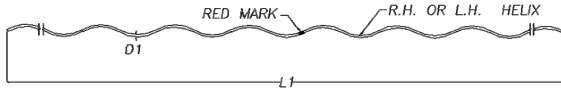

No.	Part No.	Dimensions (mm)			No. Of Rods Per Set	Lay Direction	Conductor	Weight Per Set (Kg)
		L1	D1	D2				
1	AR.08.37.AL	1200	3.7	8.37	8	L.H.	LYNX CORE (Ø8.37mm)	0.31
2	AR.09.38	1270	4.2	9.8	9	L.H.	7No.8 (Ø 9.78mm) & CANARY CORE (Ø 9.84 mm)	0.44
3	AR.10.55	1370	4.2	10.56	10	L.H.	CURLEW CORE (Ø 10.56 mm)	0.53
4	AR.12.34	1500	4.2	12.34	10	L.H.	7No.6 (Ø 12.34mm)	0.63
5	AR.12.90	1550	4.2	12.9	11	L.H.	100 mm <sup>2</sup> (Ø 12.9 mm)	0.72
6	AR.13.87	1520	5.2	13.86	10	L.H.	7No.5 (Ø 13.87mm)	0.93

## ARMOUR RODS

For galvanized earth wires

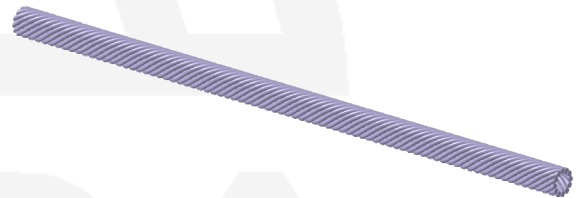
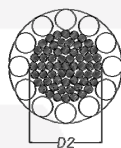
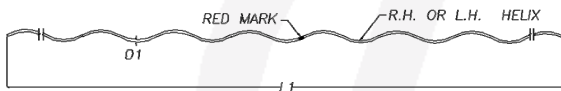

No.	Part No.	Dimensions (mm)			No. Of Rods Per Set	Lay Direction	Conductor	Weight Per Set (Kg)
		L1	D1	D2				
1	AR.06.00.ST	760	3	6	8	R.H.	PARTRIDGE CORE	0.34
2	AR.07.85.ST	875	3	8.04	10	R.H.	HAWK CORE	0.5
3	AR.08.30.ST	1170	3	8.37	10	L.H.	LYNX CORE	0.67
4	AR.09.38.01.ST	1270	3	9.8	11	L.H.	7No.8 (Ø 9.78mm) & CANARY CORE (Ø 9.84mm)	0.8
5	AR.09.96	1320	3	9.96	11	L.H.	3No.5	0.84
6	AR.10.55.ST	1370	3	10.56	11	L.H.	CURLEW CORE	0.87
7	AR.11.00	1370	3	11	12	L.H.	7No.7 (Ø 11mm)	0.95
8	AR.12.05.ST	1420	3	12.05	13	L.H.	MARTIN CORE	1.08

**ALDA MANUFACTURING CO.**

No. 7, Maryam Alley, Hakim Highway, Tehran-Iran ■ Postal Code: 1473666751

Tel: (+9821) 44003214-6 ■ Fax: (+9821) 44003217

Email: [Info@AldaCompany.com](mailto:Info@AldaCompany.com)